



**Whiteways  
Bradford  
West Yorkshire  
BD2 4BJ**

**Offers In Excess Of £179,000**

**bettermove**

# Whiteways

## Bradford

Bettermove are proud to present this 3 bedroom semi-detached house in Bradford, available with no forward chain.

The property is offered vacant and presents an ideal opportunity for buyers seeking a home requiring minor cosmetic updating, or a strong buy-to-let investment.

The property benefits from double glazing, gas central heating throughout, and has off street parking available, along with a garage providing additional storage or parking.

The council tax band is B. This is a freehold property.

The interior of this well-proportioned property comprises a spacious living room and fitted kitchen on the ground floor. The first floor consists of three bedrooms and the family bathroom. The exterior boasts a private rear garden, perfect for enjoying the summer months.

Located in the popular area of Bradford, the property is close to a range of amenities, including shops, supermarkets, restaurants and pubs. Excellent transport connections can be found from Bradford city centre and surrounding areas.

This exciting opportunity should not be missed. All enquiries can be made through Bettermove.





Approx Gross Internal Area  
105 sq m / 1134 sq ft

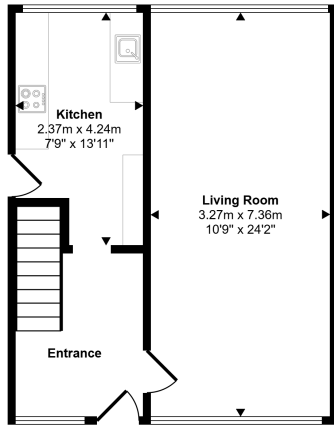

Ground Floor  
Approx 42 sq m / 457 sq ft

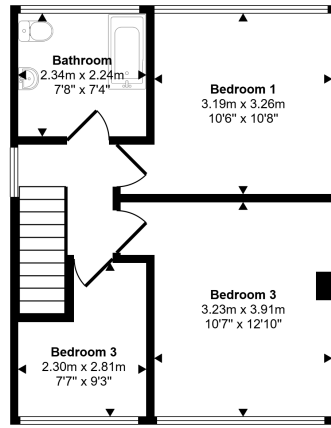

First Floor  
Approx 42 sq m / 451 sq ft

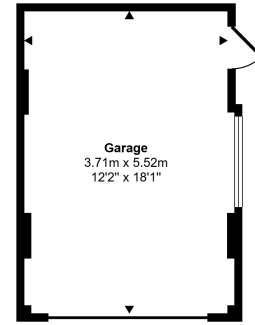

Garage  
Approx 21 sq m / 225 sq ft

Whilst every attempt has been made to ensure the accuracy of the floor plan contained here, measurements of doors, windows, rooms and any other items are approximate and no responsibility is taken for any error, omission, or mis-statement. The measurements should not be relied upon for valuation, transaction and/or funding purposes. This plan is for illustrative purposes only and should be used as such by any prospective purchaser or tenant.



20-22 Bridge End, Leeds, LS1 4DJ  
t: 0330 004 0050 e: hello@bettermove.co.uk  
[www.bettermove.co.uk](http://www.bettermove.co.uk)