



**Lower Shelton Road
Marston Moretaine
Bedford
MK43**

Offers In Excess Of £435,000

bettermove

Lower Shelton Road Bedford

Bettermove are proud to present this 3 bedroom detached bungalow in Marston Moretaine.

This property benefits from double glazing, solar panels, and gas central heating throughout, with off street parking available via the driveway and garage.

The council tax band is D.

The interior of this beautifully presented property comprises a spacious living room, dining room, fitted kitchen, three bedrooms, including two doubles, and one single, alongside the shower room. The exterior boasts a private rear garden, mainly laid to lawn, perfect for enjoying the summer months.

Located in the popular village of Marston Moretaine, the property is close to a range of amenities, including shops, supermarkets, restaurants and pubs. Excellent transport connections can be found from Stewartby train station (3.0 miles), a variety of local bus routes, and quick access to the A421.

This exciting opportunity should not be missed. All enquiries can be made through Bettermove.



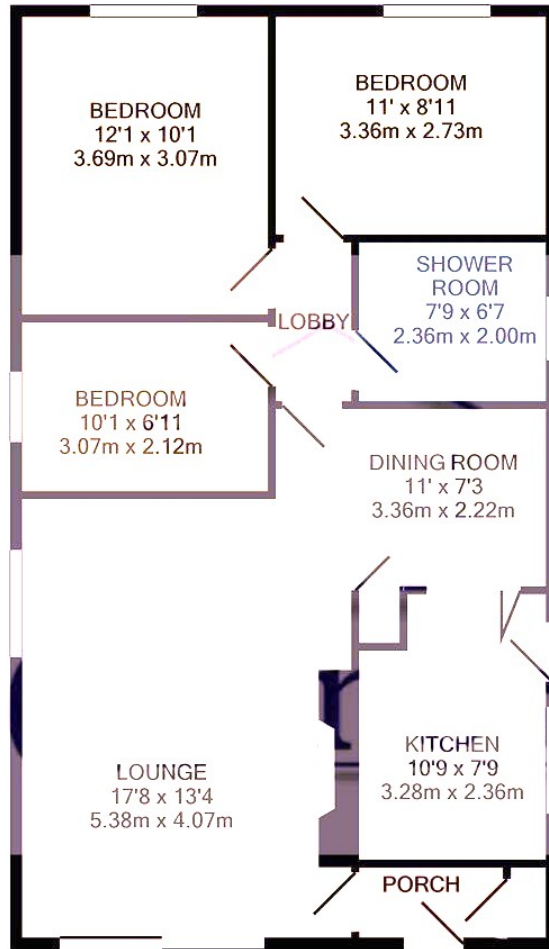



20-22 Bridge End, Leeds, LS1 4DJ
t: 0330 004 0050 e: hello@bettermove.co.uk
www.bettermove.co.uk