



**The Hollies  
Cheslyn Hay  
Walsall  
Staffordshire  
WS6 7BF**

**Offers In Excess Of £120,000**

**bettermove**

# The Hollies

## Walsall

Bettermove are proud to present this 2 bedroom flat in Cheslyn Hay.

The property benefits from double glazing, electric heating throughout and has off street parking available.

The council tax band is B.

This is a leasehold property with 136 years remaining on the lease; the ground rent is £500pa and the service charge is £2,100pa.

The interior of this beautifully presented property comprises a spacious living room, fitted kitchen, 2 bedrooms and the family bathroom.

Located in the popular village of Cheslyn Hay, the property is close to a range of amenities, including shops, supermarkets, restaurants and pubs. Excellent transport connections can be found from the A34, Landywood train station and many local bus routes.

This exciting opportunity should not be missed. All enquiries can be made through Bettermove.



The Hollies, Cheslyn Hay, Walsall, Staffordshire  
Approximate Gross Internal Area  
55 Sq M/592 Sq Ft

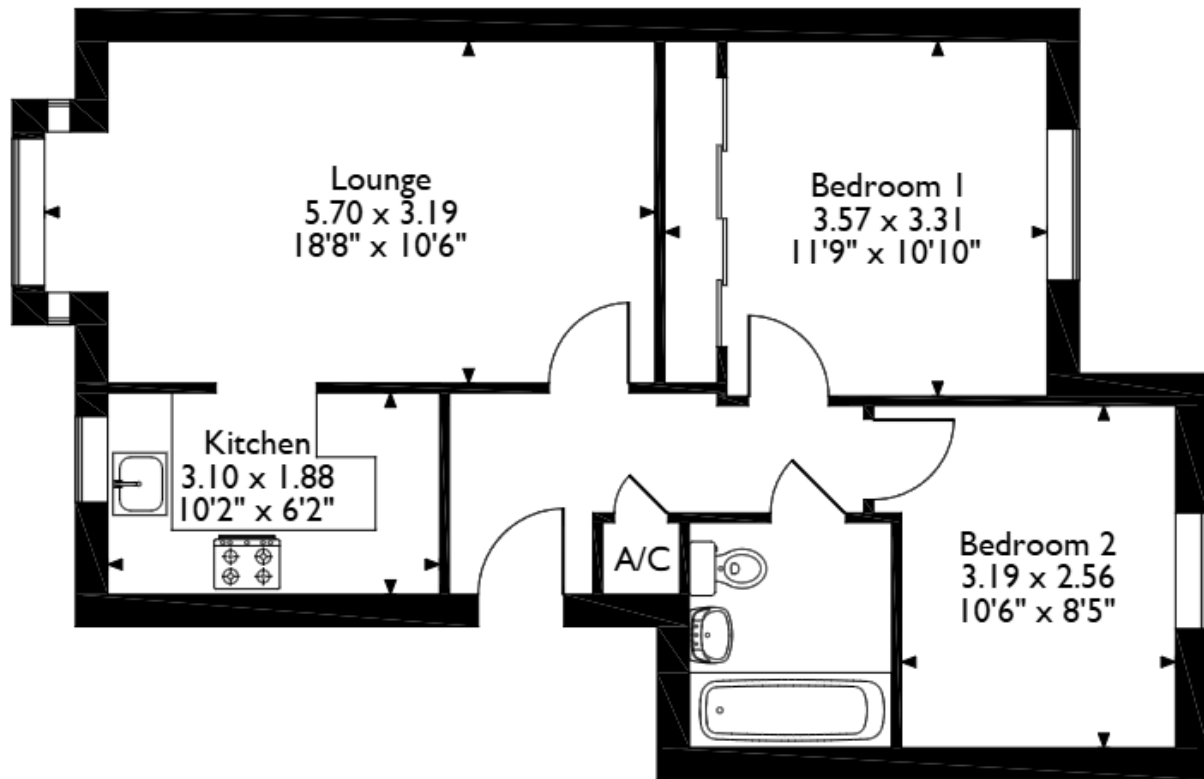

Please note that the location of doors, windows and other items are approximate and this floorplan is to be used for illustrative purposes only. Unauthorized reproduction is prohibited.



20-22 Bridge End, Leeds, LS1 4DJ  
t: 0330 004 0050 e: hello@bettermove.co.uk  
[www.bettermove.co.uk](http://www.bettermove.co.uk)