



Castle Street
Grimsby
Lincolnshire
DN32 7LB

Offers In Excess Of £75,000

bettermove

Castle Street Grimsby

Bettermove are proud to present this 2 bedroom end of terraced house in Grimsby available with no forward chain.

The property benefits from double glazing, gas central heating throughout and has on street parking available.

The council tax band is A.

The interior of this beautifully presented property comprises a spacious living room and fitted kitchen on the ground floor. The first floor consists of 2 bedrooms and the family bathroom. The exterior boasts a private rear garden, perfect for enjoying the summer months.

Located in the popular town of Grimsby, the property is close to a range of amenities, including shops, supermarkets, restaurants and pubs. Excellent transport connections can be found from the A16, New Clee train station and many local bus routes.

This exciting opportunity should not be missed. All enquiries can be made through Bettermove.



Castle Street, Grimsby, DN32

Approximate Area = 598 sq ft / 55.6 sq m

Outbuilding = 95 sq ft / 8.8 sq m

Total = 693 sq ft / 64.4 sq m

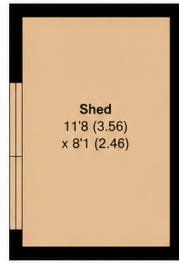

OUTBUILDING

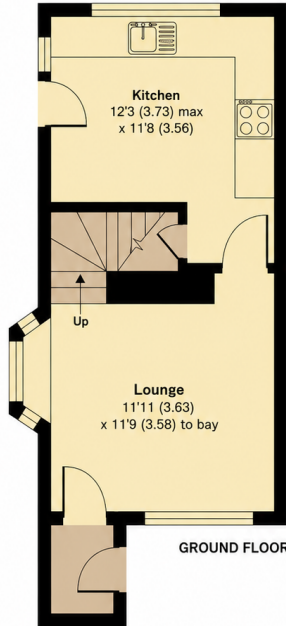

GROUND FLOOR

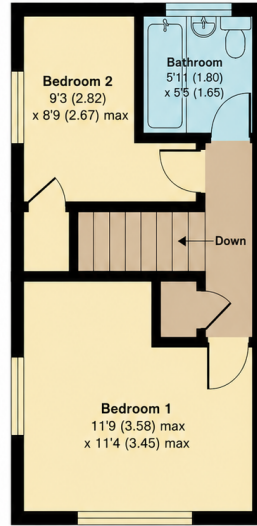

FIRST FLOOR



20-22 Bridge End, Leeds, LS1 4DJ
t: 0330 004 0050 e: hello@bettermove.co.uk
www.bettermove.co.uk