



**Malpas Court
Northallerton
North Yorkshire
DL7 8TG**

Offers In Excess Of £122,000

bettermove

Malpas Court Northallerton

Bettermove are proud to present this 2 bedroom retirement flat in Northallerton available with no forward chain.

The property benefits from double glazing, gas central heating throughout and has off street parking available.

The council tax band is D.

This is a leasehold property with 111 years remaining on the lease; the ground rent is £450pa and the service charge is £1,100pcm.

The interior of this beautifully presented property comprises a spacious living room, fitted kitchen, 2 bedrooms and the family bathroom.

Located in the popular town of Northallerton, the property is close to a range of amenities, including shops, supermarkets, restaurants and pubs. Excellent transport connections can be found from the A168 and Northallerton train station.

This exciting opportunity should not be missed. All enquiries can be made through Bettermove.



Malpas Court, Northallerton
Approximate Gross Internal Area
73 Sq M/786 Sq Ft

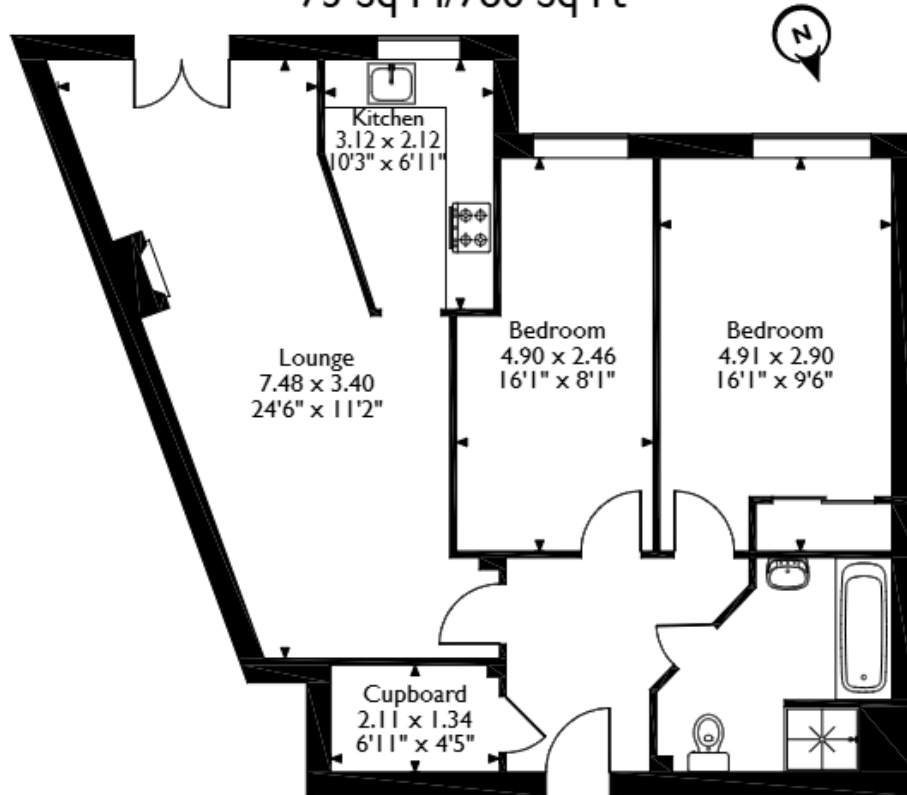

First Floor Flat

Please note that the location of doors, windows and other items are approximate and this floorplan is to be used for illustrative purposes only. Unauthorized reproduction is prohibited.



20-22 Bridge End, Leeds, LS1 4DJ
t: 0330 004 0050 e: hello@bettermove.co.uk
www.bettermove.co.uk