



**Doubletrees Court
St Blazey
Par
Cornwall
PL24**

Offers In Excess Of £160,000

bettermove

Doubletrees Court Par

Bettermove are proud to present this 2 bedroom terraced house in St Blazey.

The property benefits from double glazing, and gas central heating throughout, with one allocated parking space available.

The council tax band is A.

The interior of this well presented property comprises a spacious living room, and fitted kitchen/diner on the ground floor. The first floor consists of two double bedrooms, alongside the family bathroom. The exterior boasts a private, low maintenance rear garden, with wooden garden shed, perfect for enjoying the summer months.

Located in the popular town of St Blazey, Par, the property is close to a range of amenities, including shops, supermarkets, restaurants, pubs, and schools. Excellent transport connections can be found from Par Train Station, a variety of local bus routes, and quick access to the A390.

This exciting opportunity should not be missed. All enquiries can be made through Bettermove.



Doubletrees Court, St. Blazey, Par
Approximate Gross Internal Area
67 Sq M/721 Sq Ft

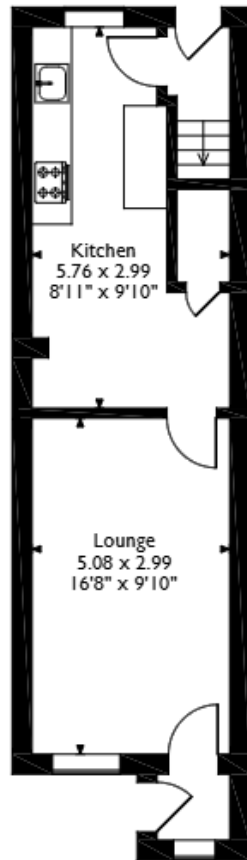

Ground Floor

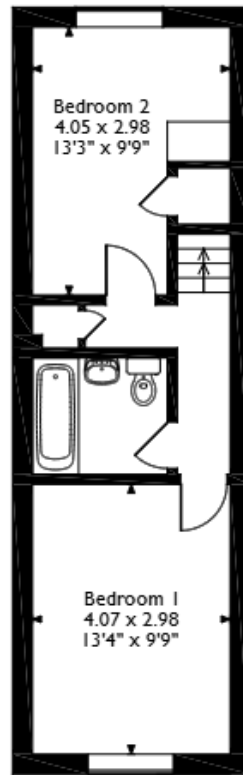

First Floor

Please note that the location of doors, windows and other items are approximate and this floorplan is to be used for illustrative purposes only. Unauthorised reproduction is prohibited.



20-22 Bridge End, Leeds, LS1 4DJ
t: 0330 004 0050 e: hello@bettermove.co.uk
www.bettermove.co.uk