



**Kings Road West
Swanage
Dorset
BH19**

Offers in Excess of £505,000

bettermove

Kings Road West Swanage

Bettermove are proud to present this 3 bedroom semi-detached house in Swanage.

The property benefits from double glazing, and gas central heating throughout, with off street parking available via the driveway and garage.

The council tax band is D.

The interior of this beautifully presented and modern property comprises two spacious reception rooms, dining room, fitted kitchen/breakfast room, and a WC on the ground floor. The first floor consists of three bedrooms, including two doubles, and one single, alongside the family bathroom. The exterior boasts a private rear garden, complete with newly laid decking, perfect for enjoying the summer months, and with prime view of Swanage Steam railway.

Located in the popular coastal town of Swanage, the property is close to a range of amenities, including shops, supermarkets, restaurants, pubs, schools, and a short distance to the seafront. Excellent transport connections can be found from Swanage Railway Station, a variety of local bus routes, and quick access to the A351.

This exciting opportunity should not be missed. All enquiries can be made through Bettermove.



GROUND FLOOR
458 sq.ft. (42.6 sq.m.) approx.

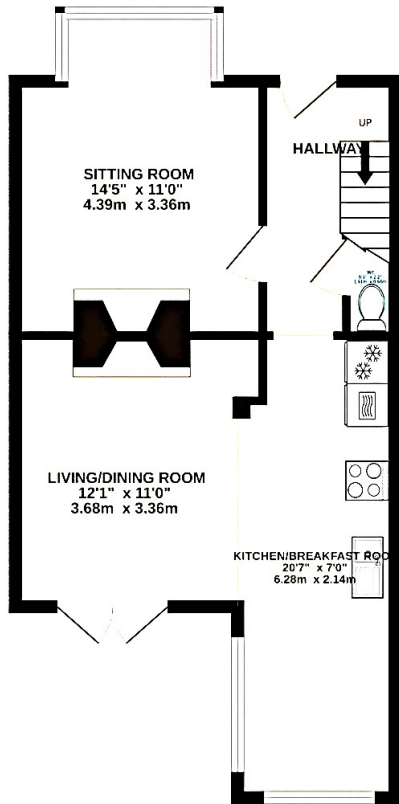

1ST FLOOR
381 sq.ft. (35.4 sq.m.) approx.

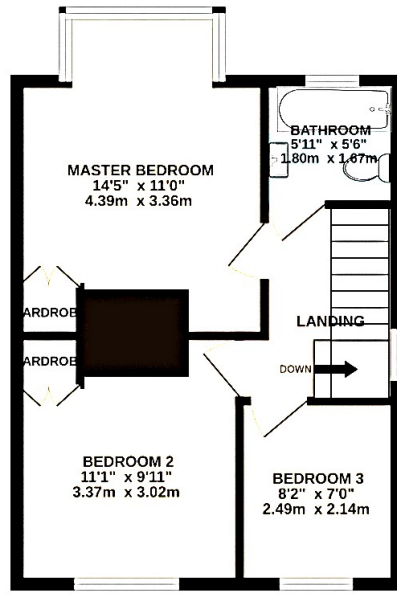



20-22 Bridge End, Leeds, LS1 4DJ
t: 0330 004 0050 e: hello@bettermove.co.uk
www.bettermove.co.uk