



**Somerset Close  
Chatham  
Kent  
ME5**

**Offers in Excess of £280,000**

**bettermove**

# Somerset Close Chatham

Bettermove are proud to present this 3 bedroom terraced house in Chatham, available with no forward chain.

The property benefits from double glazing, and gas central heating throughout, with off street, communal parking available.

The council tax band is B.

The interior of this beautifully presented property comprises a spacious, open-plan living/dining area, fitted kitchen, with additional pantry, and WC on the ground floor. The first floor consists of three double bedrooms, alongside a shower room. Outside, the property boasts a private rear garden, with both patio and artificial lawn areas, perfect for enjoying the summer months.

Located in the popular town of Chatham, the property is close to a range of amenities, including shops, supermarkets, restaurants, pubs, and schools. Excellent transport connections can be found from Chatham Train Station, a variety of local bus routes, and quick access to the M2.

This exciting opportunity should not be missed. All enquiries can be made through Bettermove.



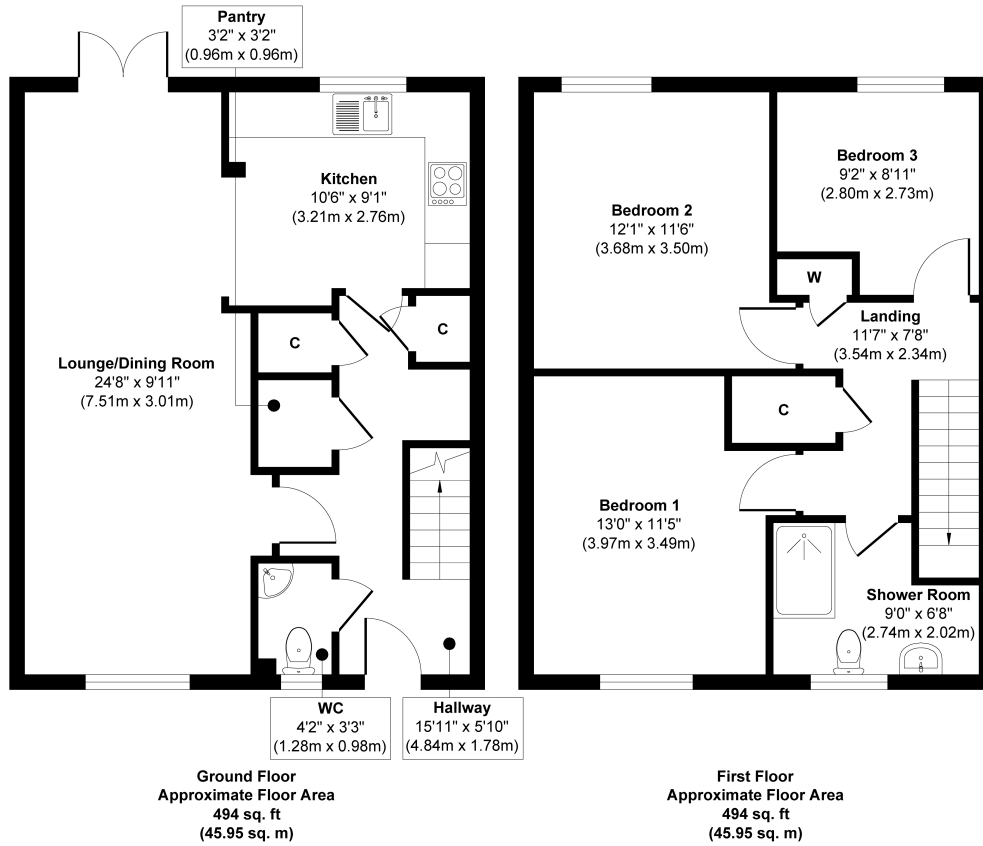

**Approx. Gross Internal Floor Area 988 sq. ft / 91.90 sq. m**

Whilst every attempt has been made to ensure the accuracy of the floor plan contained here, measurements of doors, windows, rooms and any other items are approximate and no responsibility is taken for any error, omission, or mis-statement. The measurements should not be relied upon for valuation, transaction and/or funding purposes. This plan is for illustrative purposes only and should be used as such by any prospective purchaser or tenant.

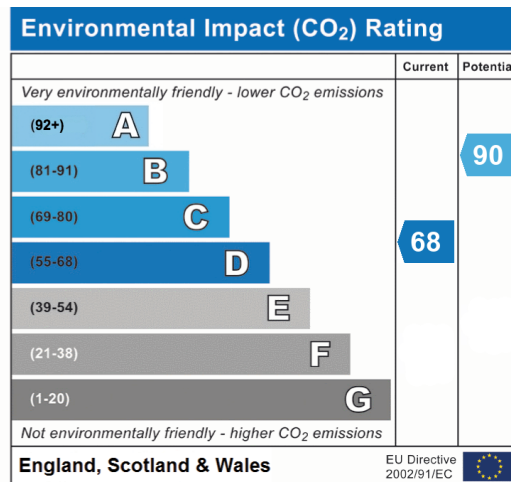
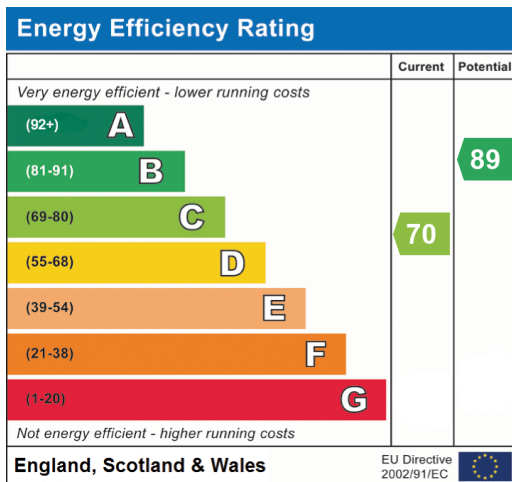



20-22 Bridge End, Leeds, LS1 4DJ  
t: 0330 004 0050 e: hello@bettermove.co.uk  
[www.bettermove.co.uk](http://www.bettermove.co.uk)