



**The Hawthorns
Lutterworth
Leicestershire
LE17 4UL**

Offers In Excess Of £100,000

bettermove

The Hawthorns

Lutterworth

A SPACIOUS 2 BEDROOM MAISONETTE in Lutterworth, available VACANT for IMMEDIATE possession and CHAIN FREE. Call to enquire!

Bettermove are proud to present this 2 bedroom Maisonette in Lutterworth, available with no forward chain.

This is a leasehold property with 62 years remaining on the lease. The service charge is approximately £3,000pa and the ground rent is £100pa.

The property benefits from double glazing, and electric heating throughout, with off street parking available.

The council tax band is C.

The interior of this property comprises a spacious living area, fitted kitchen, 2 bedrooms and the family bathroom.

Located in the popular town of Lutterworth, the property is close to a range of amenities, including shops, supermarkets, restaurants and pubs.

This exciting opportunity should not be missed. All enquiries can be made through Bettermove.



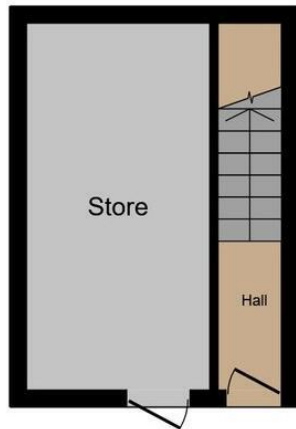

Ground Floor



First Floor

Total floor area 77.4 sq.m. (833 sq.ft.) approx

This floor plan is for illustrative purposes only. It is not drawn to scale. Any measurements, floor areas (including any total floor area), openings and orientation are approximate. No details are guaranteed, they cannot be relied upon for any purpose and they do not form part of any agreement. No liability is taken for any error, omission or misstatement. A party must rely upon its own inspection(s). Powered by www.focalagent.com



20-22 Bridge End, Leeds, LS1 4DJ
t: 0330 004 0050 e: hello@bettermove.co.uk
www.bettermove.co.uk