



Reedsdale Avenue
Morley
Leeds
West Yorkshire
LS27

Offers In Excess Of £234,000

bettermove

Reedsdale Avenue

Leeds

Bettermove are proud to present this 2 bedroom terraced house in Morley.

The property benefits from double glazing, gas central heating throughout and has off street parking available via 2 allocated spaces.

The council tax band is C.

The interior of this beautifully presented property comprises a spacious living room and fitted kitchen that includes a dining area on the ground floor. The first floor consists of 2 bedrooms and the family bathroom. The exterior boasts a private rear garden, perfect for enjoying the summer months.

Located in the popular town of Morley, the property is close to a range of amenities, including shops, supermarkets, restaurants and pubs. Excellent transport connections can be found from Morley train station, various bus routes and the M1 and A1(M).

This exciting opportunity should not be missed. All enquiries can be made through Bettermove.



▼ **Ground Floor** TOTAL AREA: 27.13 m² • LIVING AREA: 27.13 m² •

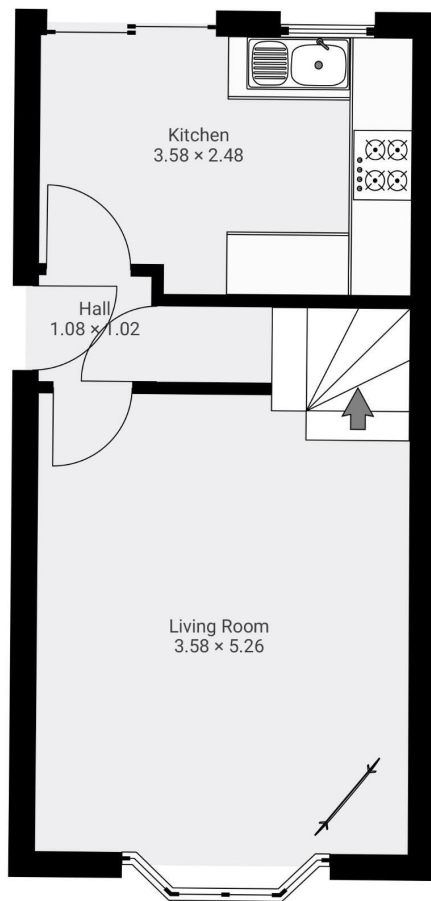

▼ **1st Floor** TOTAL AREA: 26.52 m² • LIVING AREA: 26.52 m² •

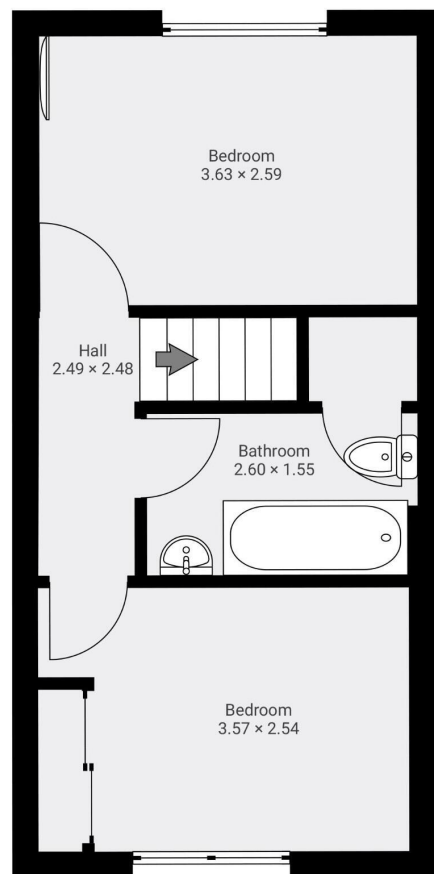

DETAILS
Total area: 53.64 m²
Living area: 53.64 m²

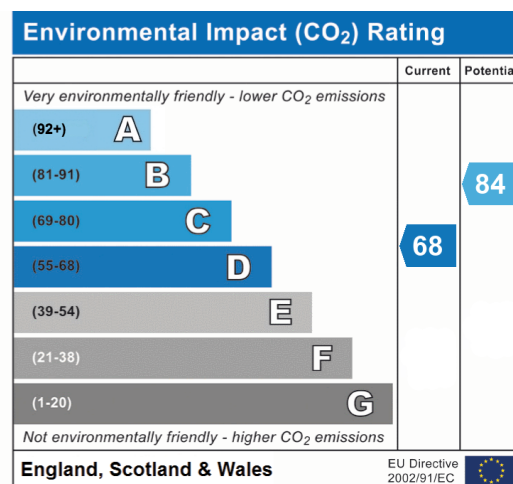
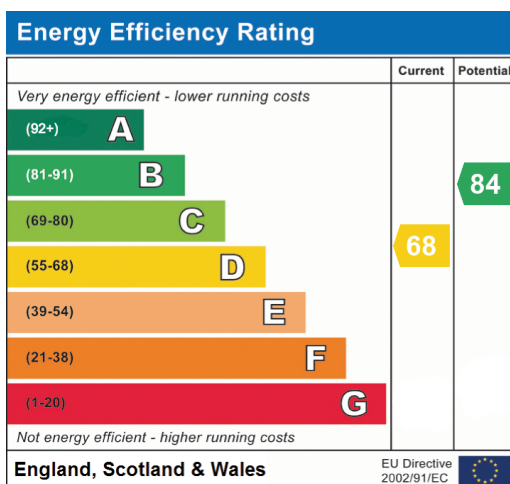



20-22 Bridge End, Leeds, LS1 4DJ
t: 0330 004 0050 e: hello@bettermove.co.uk
www.bettermove.co.uk