



**Glebe Road
Thorne
Doncaster
South Yorkshire
DN8**

Offers in Excess of £78,000

bettermove

Glebe Road

Doncaster

Bettermove are proud to present this 2 bedroom flat in Thorne, available with no forward chain.

The property benefits from double glazing, and electric heating throughout, with communal parking available to the rear of the property.

The council tax band is A.

This is a leasehold property with 88 years remaining on the lease; the ground rent is £10.00 per annum, and the service charge is £150.00 per annum.

The interior of this well presented, first floor property, comprises a spacious living room, fitted kitchen, two bedrooms, and a family bathroom.

Located in the popular town of Thorne, Doncaster, the property is close to a range of amenities, including shops, supermarkets, restaurants and pubs. Excellent transport connections can be found from Thorne North, and Thorne South Train Stations, a variety of local bus routes, and quick access to the M18.

This exciting opportunity should not be missed. All enquiries can be made through Bettermove.



Glebe Road, Thorne, Doncaster
Approximate Gross Internal Area
49 Sq M/527 Sq Ft

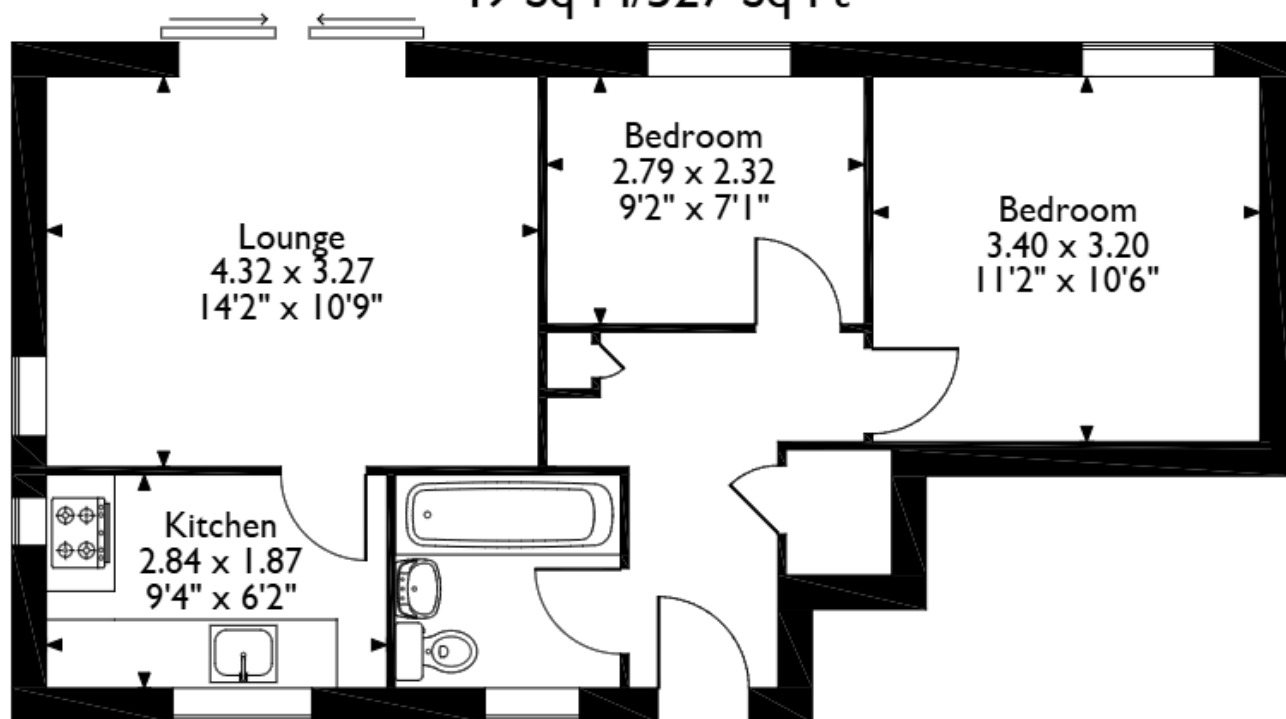

First Floor Flat

Please note that the location of doors, windows and other items are approximate and this floorplan is to be used for illustrative purposes only. Unauthorized reproduction is prohibited.



20-22 Bridge End, Leeds, LS1 4DJ
t: 0330 004 0050 e: hello@bettermove.co.uk
www.bettermove.co.uk