



Lorne Road
Barrow-in-Furness
Cumbria
LA13

Offers in Excess of £180,000

bettermove

Lorne Road

Barrow-in-Furness

Bettermove are proud to present this 4 bedroom terraced house in Barrow-in-Furness, available with no forward chain.

This property benefits from double glazing, and gas central heating throughout, with on street parking available.

The council tax band is A.

This impressive three-storey property is beautifully presented throughout. The ground floor features a living room, dining room, and a well-appointed fitted kitchen. On the first floor, you'll find two generously sized bedrooms, a versatile third room—ideal as a home office, nursery, or playroom—and a stylish family bathroom. The second floor provides two additional bedrooms. Outside, the property benefits from an attached garage and a private rear yard, perfect during the summer months.

Located in the popular coastal town of Barrow-in-Furness, the property is close to a range of amenities, including shops, supermarkets, restaurants, pubs, schools, and a short distance to the seafront. Excellent transport links can be found from Barrow-in-Furness (0.5 mile) Train Station, a variety of local bus routes, and quick access to the A590, leading to the M6.

This exciting opportunity should not be missed! All enquiries can be made through Bettermove.



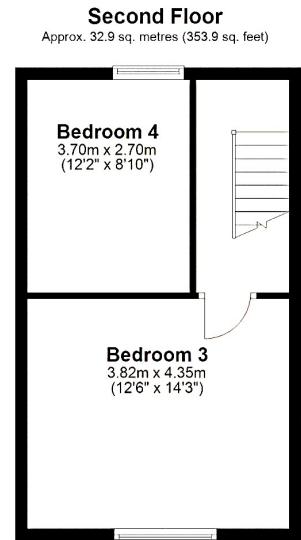
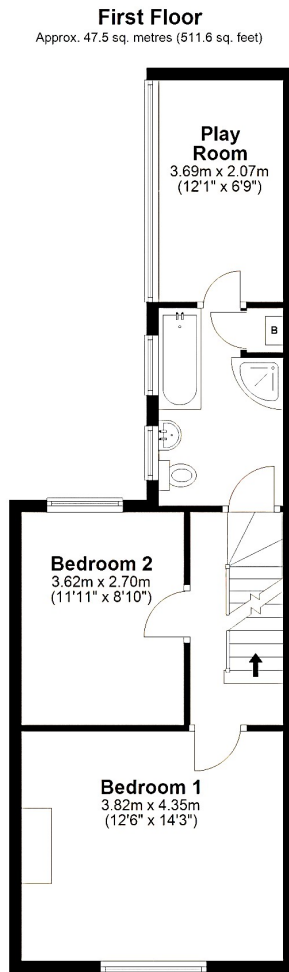
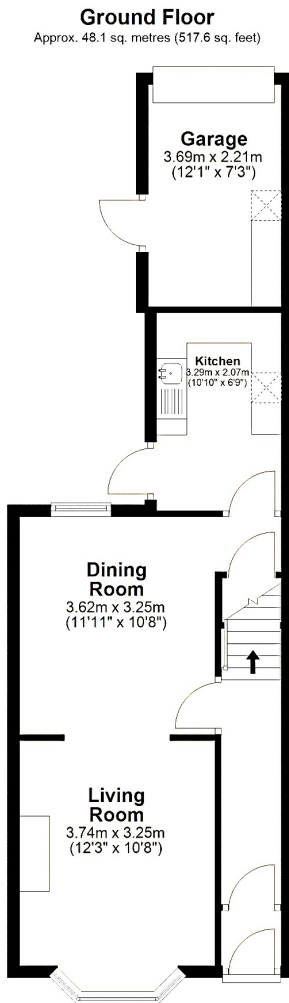

Total area: approx. 128.5 sq. metres (1383.2 sq. feet)

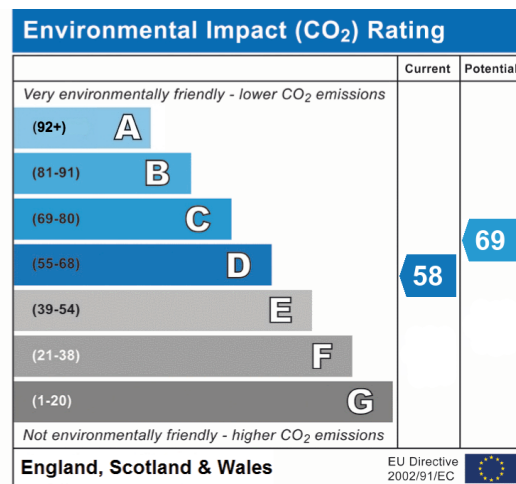
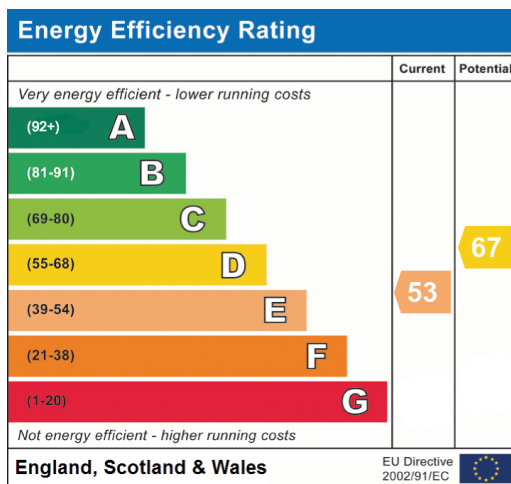



20-22 Bridge End, Leeds, LS1 4DJ
t: 0330 004 0050 e: hello@bettermove.co.uk
www.bettermove.co.uk