



Dixon Green Drive
Farnworth
Bolton
Lancashire
BL4

Offers In Excess Of £105,000

bettermove

Dixon Green Drive

Bolton

Bettermove are proud to present this 2 bedroom flat in Farnworth, available with no forward chain.

This property benefits from double glazing, and electric heating throughout, with allocated parking available.

The council tax band is A.

This is a leasehold property with 971 years remaining on the lease; the service charge is £217.00 per month.

The interior of this beautifully presented, ground floor property comprises a spacious, open-plan living and dining area, fitted kitchen, two double bedrooms, and a family bathroom.

Located in the popular town of Farnworth, Bolton, the property is close to a range of amenities, including shops, supermarkets, restaurants, and pubs. Excellent transport links can be found from Moses Gate Train Station, a variety of local bus routes, and quick access to St Peter's Way, leading to the M61, and M60.

This exciting opportunity should not be missed! All enquiries can be made through Bettermove.



Approx Gross Internal Area
50 sq m / 539 sq ft

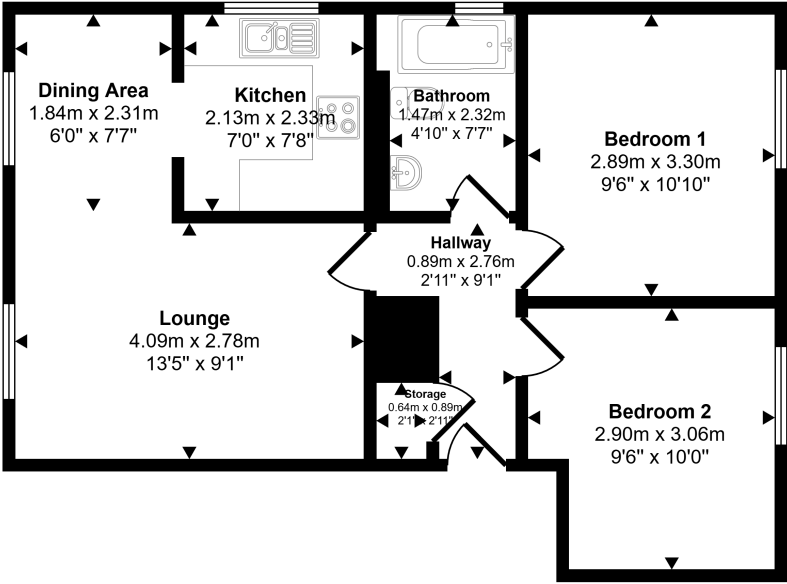
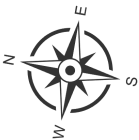

Floorplan

Whilst every attempt has been made to ensure the accuracy of the floor plan contained here, measurements of doors, windows, rooms and any other items are approximate and no responsibility is taken for any error, omission, or mis-statement. The measurements should not be relied upon for valuation, transaction and/or funding purposes. This plan is for illustrative purposes only and should be used as such by any prospective purchaser or tenant.

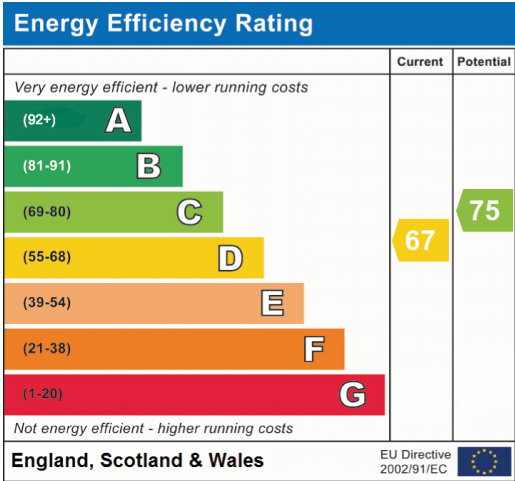



20-22 Bridge End, Leeds, LS1 4DJ
t: 0330 004 0050 e: hello@bettermove.co.uk
www.bettermove.co.uk