



**Apollo Avenue
Bury
Lancashire
BL9 8HG**

Offers in Excess of £325,000

bettermove

Apollo Avenue

Bury

Bettermove are proud to present this 4 bedroom semi-detached house in Bury, available with no forward chain.

This property benefits from double glazing, and gas central heating throughout, with off road parking available for two cars, via the driveway.

The council tax band is C.

The interior of this beautifully presented property comprises a spacious living room, a second living room/dining room, kitchen/breakfast room, utility room, and shower room on the ground floor. The first floor consists of four bedrooms, and a family bathroom. Outside, the property boasts a private, low maintenance garden, perfect for enjoying the summer months.

Located in the popular town of Bury, the property is close to a range of amenities, including shops, supermarkets, restaurants, pubs, and schools. Excellent transport links can be found from Whitefield Tram Stop, a variety of local bus routes, and quick access to the M66.

This exciting opportunity should not be missed! All enquiries can be made through Bettermove.



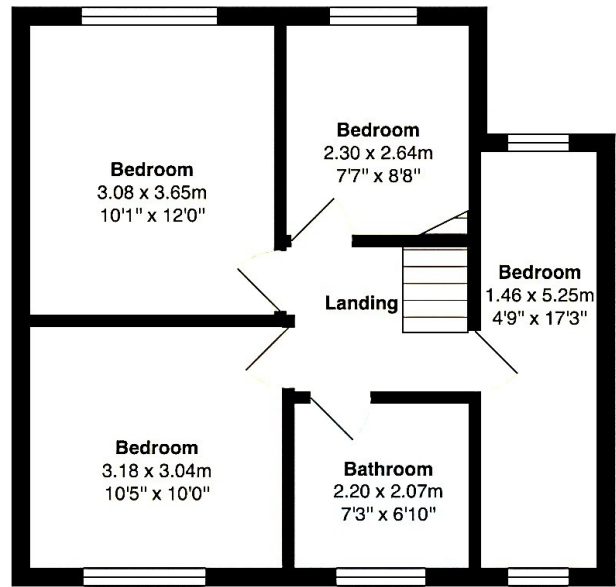
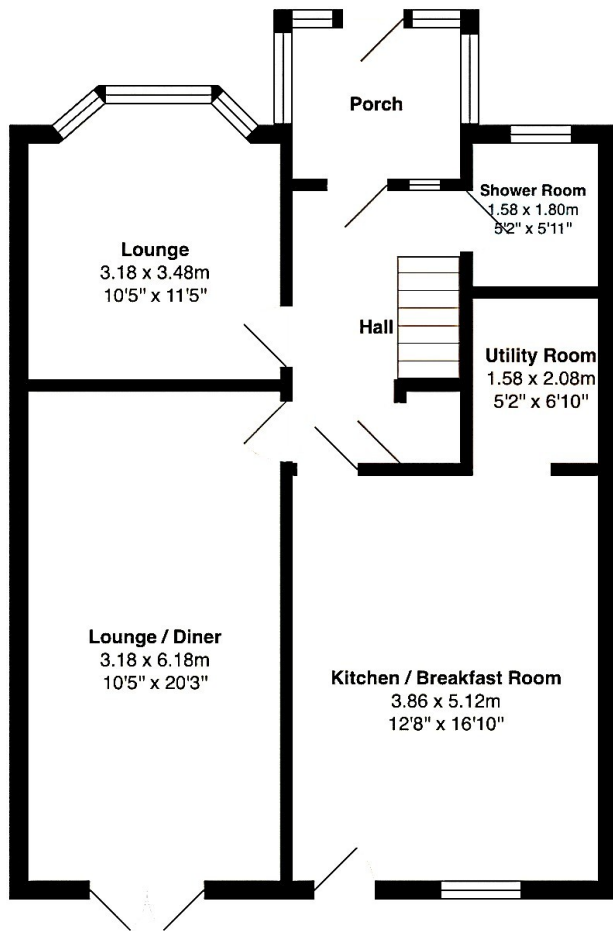

Total Area: 117.6 m² ... 1266 ft²

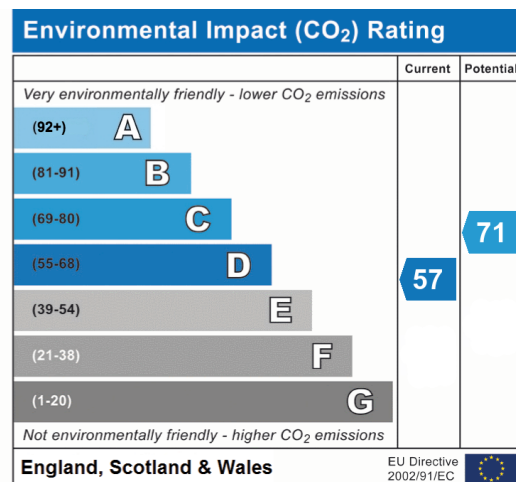
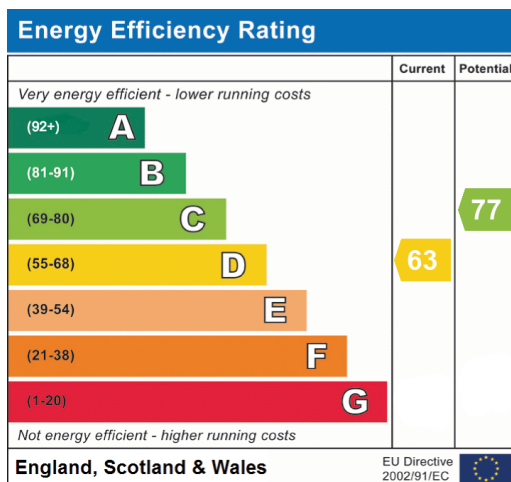



20-22 Bridge End, Leeds, LS1 4DJ
t: 0330 004 0050 e: hello@bettermove.co.uk
www.bettermove.co.uk