



**Gateway Terrace
Portishead
Bristol
Somerset
BS20**

Offers in Excess of £234,000

bettermove

Gateway Terrace

Bristol

Bettermove are proud to present this 2 bedroom flat in Portishead, available with no forward chain.

This is currently a tenanted property and will be sold with tenants in situ for immediate investment. Rental yields can be obtained through Bettermove.

The property benefits from double glazing, and gas central heating throughout, with one allocated parking space available.

The council tax band is C.

This is a leasehold property with 980 years remaining on the lease.

The interior of this beautifully presented, top floor property, comprises a spacious, open-plan living/kitchen area, two double bedrooms, and a family bathroom.

Located in the popular coastal town of Portishead, Bristol, the property is close to a range of amenities, including shops, supermarkets, restaurants, pubs, and short distance to the Marina and Seafront. Excellent transport links can be found from Avonmouth (6.3 miles), a variety of local bus routes, and quick access to the M5.

This exciting investment opportunity should not be missed! All enquiries can be made through Bettermove.



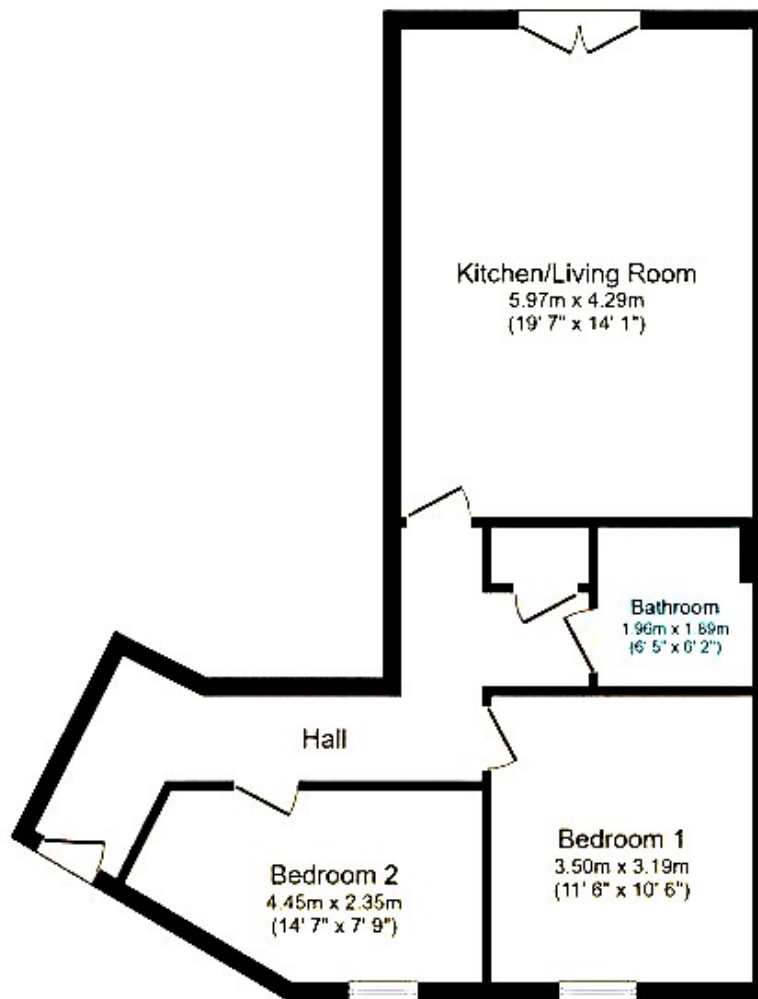

Energy Efficiency Rating		
	Current	Potential
Very energy efficient - lower running costs		
(92+) A		
(81-91) B		
(69-80) C	80	80
(55-68) D		
(39-54) E		
(21-38) F		
(1-20) G		
Not energy efficient - higher running costs		
England, Scotland & Wales		
	EU Directive 2002/91/EC	

Environmental Impact (CO ₂) Rating		
	Current	Potential
Very environmentally friendly - lower CO ₂ emissions		
(92+) A		
(81-91) B		
(69-80) C	82	82
(55-68) D		
(39-54) E		
(21-38) F		
(1-20) G		
Not environmentally friendly - higher CO ₂ emissions		
England, Scotland & Wales		
	EU Directive 2002/91/EC	



20-22 Bridge End, Leeds, LS1 4DJ
t: 0330 004 0050 e: hello@bettermove.co.uk
www.bettermove.co.uk