



Mill Gardens
Blackpill
Swansea
West Glamorgan
SA3

Offers in Excess of £152,000

bettermove

Mill Gardens Swansea

Bettermove are proud to present this 1 bedroom Park Home in Blackpill, available with no forward chain.

The property benefits from double glazing and Gas LPG throughout, with a private driveway available.

The council tax band is A.

The park site fees are £180.84 per month.

The interior of this beautifully presented property comprises a spacious living room, fitted kitchen, one double bedroom and a shower room. The exterior boasts a private terrace, with decking and lawn areas, perfect for enjoying the summer months.

Located in the popular suburban area of Blackpill, Swansea, the property is close to a range of amenities, including shops, supermarkets, restaurants, pubs and a short distance to the seafront. Excellent transport links can be found from Swansea Railway Station, local bus routes, and close access to the M4.

This exciting opportunity should not be missed! All enquiries can be made through Bettermove.



Mill Gardens, Blackpill, Swansea
Approximate Gross Internal Area
38 Sq M/409 Sq Ft

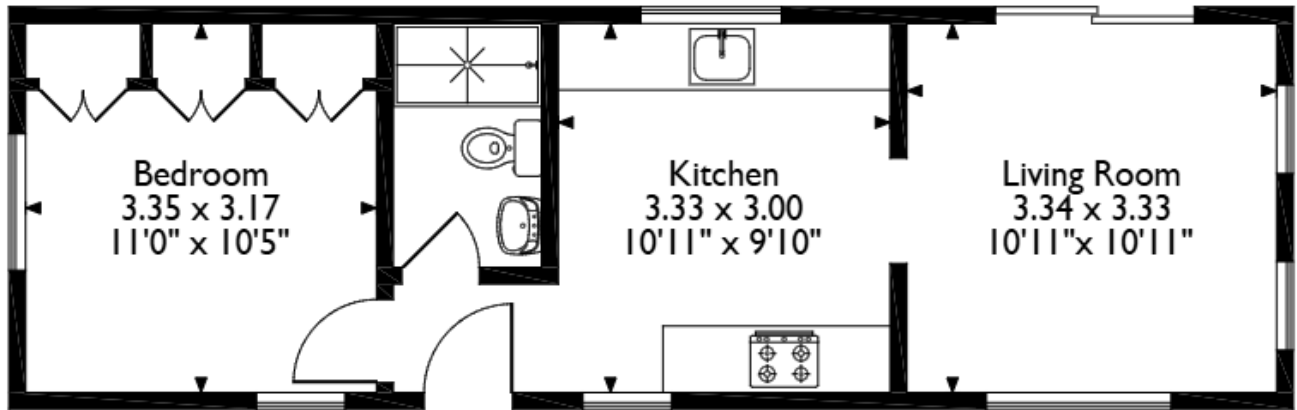

Ground Floor

Please note that the location of doors, windows and other items are approximate and this floorplan is to be used for illustrative purposes only. Unauthorized reproduction is prohibited.



20-22 Bridge End, Leeds, LS1 4DJ
t: 0330 004 0050 e: hello@bettermove.co.uk
www.bettermove.co.uk