



Myrtle Grove  
Huddersfield  
West Yorkshire  
HD3 4DX

Offers in Excess of £156,000

bettermove



# Myrtle Grove

## Huddersfield

Bettermove are proud to present this 3 bedroom End of Terrace House in Huddersfield, available with no forward chain.

The property benefits from double glazing, gas central heating throughout and has ample on street parking available nearby. The council tax band is A.

The property is tenanted and will be sold with tenants in situ for immediate investment - rental yields can be obtained through Bettermove.

The interior of this property comprises a spacious living room and the fitted kitchen with a dining area on the ground floor. The first floor consists of three bedrooms and the family bathroom with a separate WC. The exterior boasts a front, side and rear garden perfect for enjoying the summer months.

Located in the popular town of Huddersfield, the property is close to a range of amenities, including shops, supermarkets, restaurants and pubs. Excellent transport connections can be found from Lockwood Station, the M62, A62 and many local bus routes.

This exciting opportunity should not be missed! All enquiries can be made through Bettermove on 0330 004 0050.

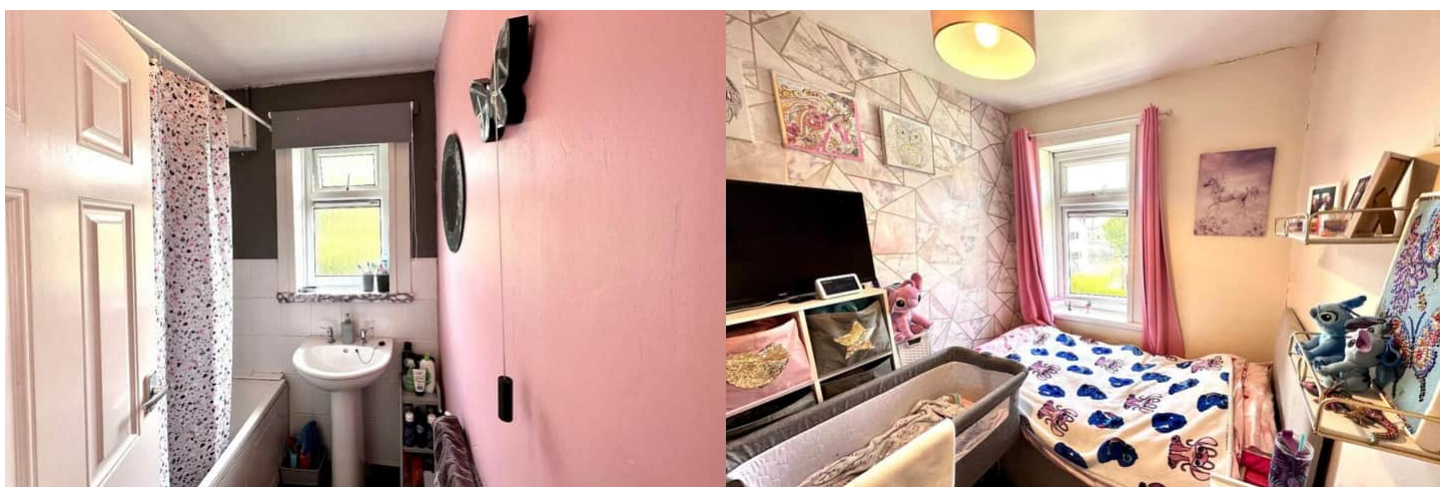

## Ground Floor

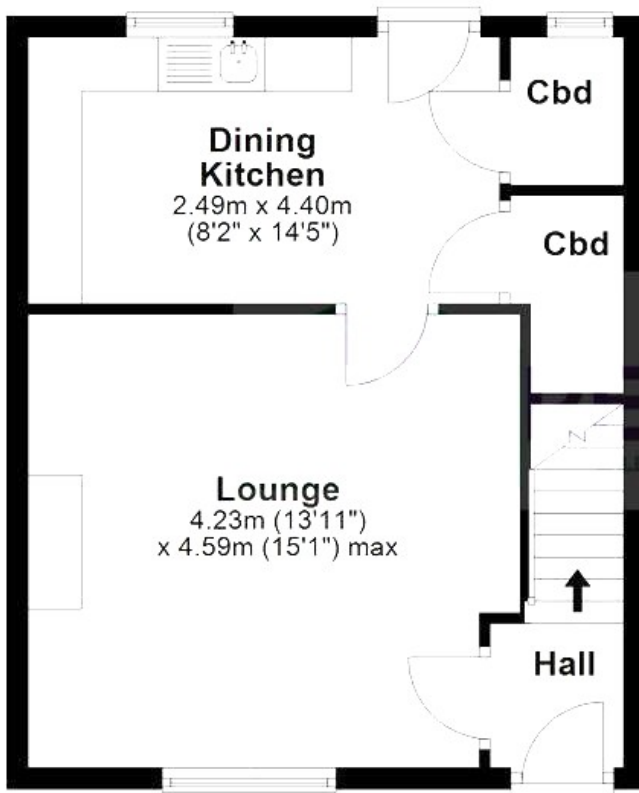

## First Floor

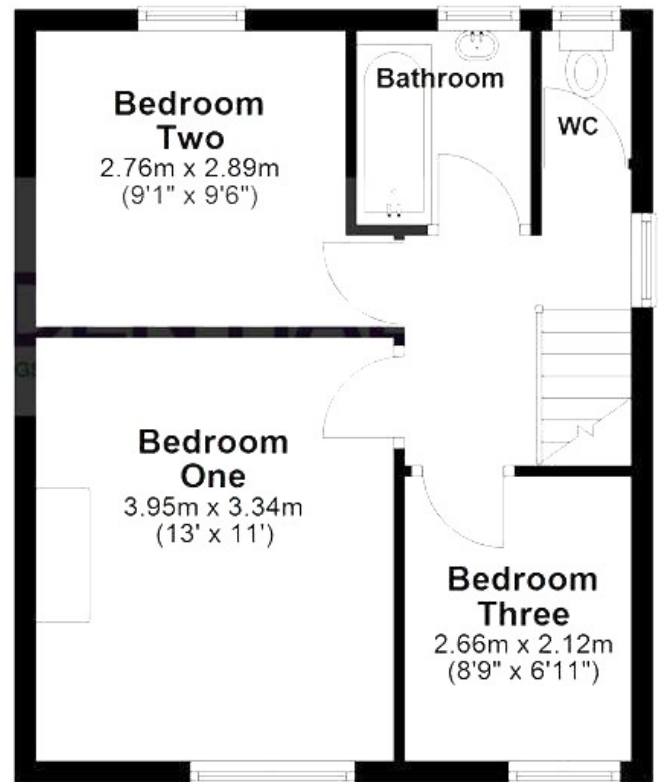

All Measurements are approximate and for display purposes only  
Plan produced using PlanUp.

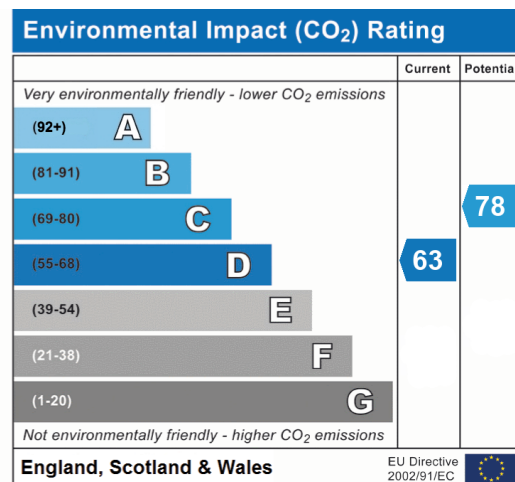
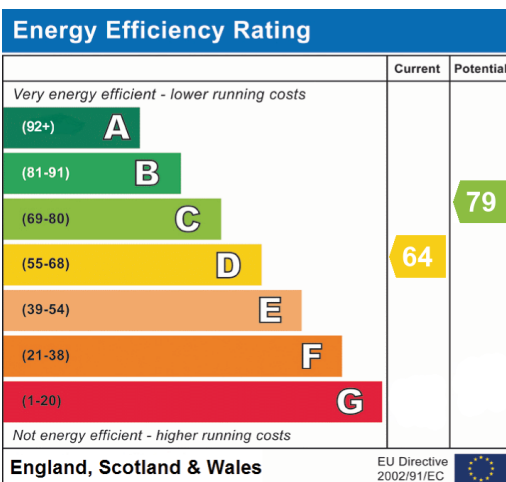





20-22 Bridge End, Leeds, LS1 4DJ  
t: 0330 004 0050 e: [hello@bettermove.co.uk](mailto:hello@bettermove.co.uk)  
[www.bettermove.co.uk](http://www.bettermove.co.uk)