



Andrew Street  
Bury  
Lancashire  
BL9

Offers In Excess Of £160,000

bettermove

# Andrew Street Bury

Bettermove are proud to present this 3 bedroom terraced house, welcoming cash buyers only.

This property benefits from double glazing and gas central heating throughout, with on street parking available.

The council tax band is A.

This is a leasehold property with 851 years remaining on the lease.

The interior of this well presented property comprises a spacious lounge and fitted kitchen on the ground floor. The first floor consists of three bedrooms and the family bathroom. The exterior boasts a side lawned garden, and a rear private garden, perfect for enjoying the summer months.

Located in the popular town of Bury, the property is just a short walk into the town centre, giving access to many local amenities, including shops, supermarkets, restaurants, pubs, schools and Bury Market. Excellent transport links can be found from Bury Tram Stop, a variety of local bus routes, and quick access to the M66, leading to the M60.

This exciting opportunity should not be missed! All enquiries can be made through Bettermove.



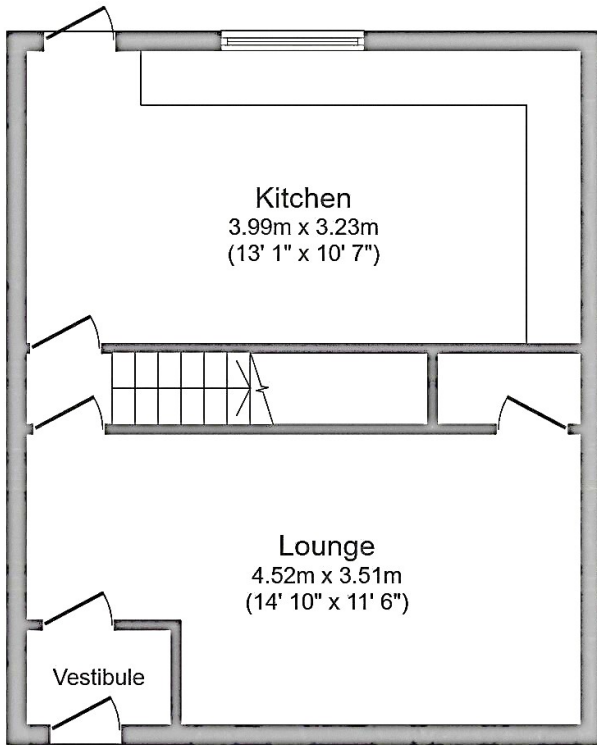

Ground Floor

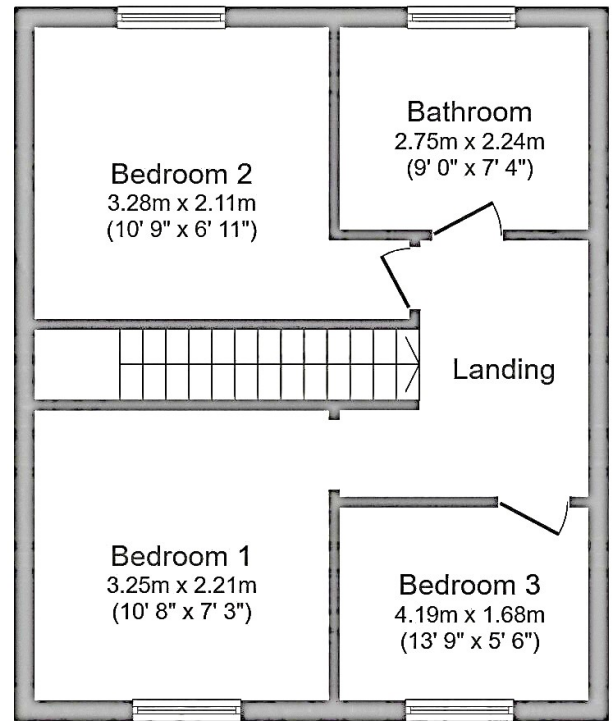

First Floor





20-22 Bridge End, Leeds, LS1 4DJ  
 t: 0330 004 0050 e: [hello@bettermove.co.uk](mailto:hello@bettermove.co.uk)  
[www.bettermove.co.uk](http://www.bettermove.co.uk)