



High Street
Girton
Newark
Nottinghamshire
NG23

Offers in Excess of £190,000

bettermove

High Street Newark

Bettermove are proud to present this 2 bedroom terraced cottage in Girton, available with no forward chain.

This property benefits from double glazing, log burners and gas central heating throughout, with on street parking available.

The council tax band is B.

The interior of this beautifully presented property comprises a spacious living room, dining room, fitted kitchen and shower room on the ground floor. The first floor consists of two double bedrooms. The exterior boasts a separate outbuilding and a private rear garden, with both patio and lawn areas, perfect for enjoying the summer months.

Located in the quiet village of Girton, Newark, the property is close to a range of amenities, including shops, supermarkets, restaurants and pubs. Excellent transport links can be found from Swinderby and Collingham Railway Stations, a variety of local bus routes, and close access to the A1.

This exciting opportunity should not be missed! All enquiries can be made through Bettermove on 0330 004 0050.



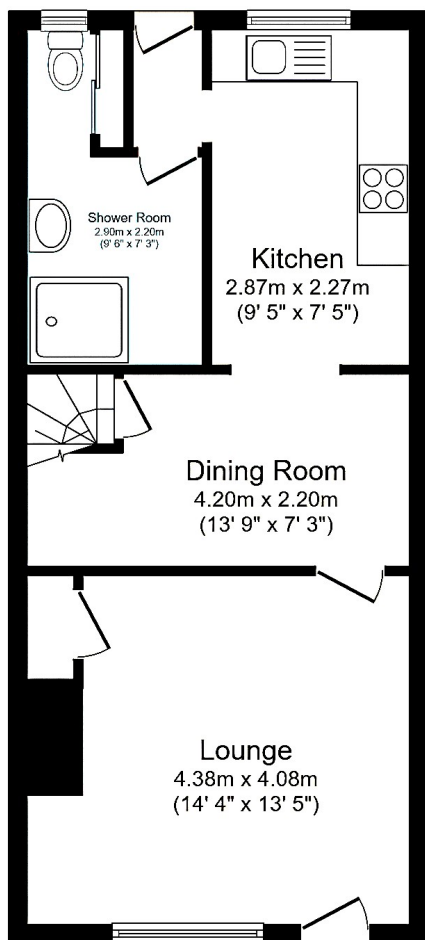

Ground Floor

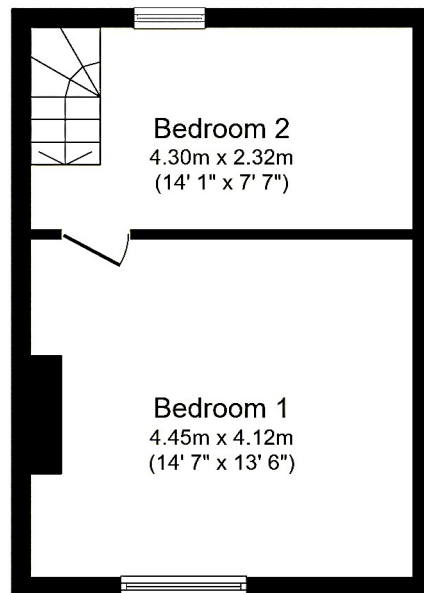

First Floor

Total floor area 72.4 m² (780 sq.ft.) approx

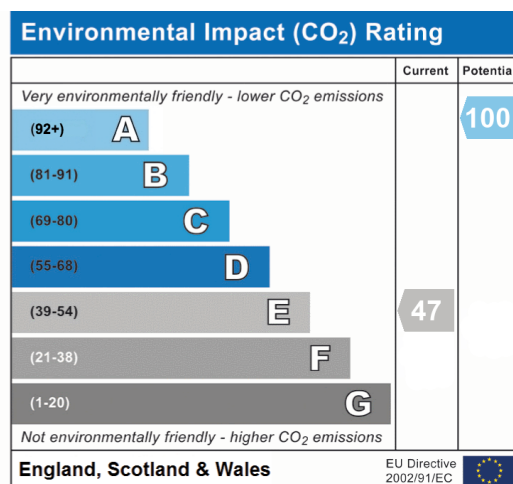
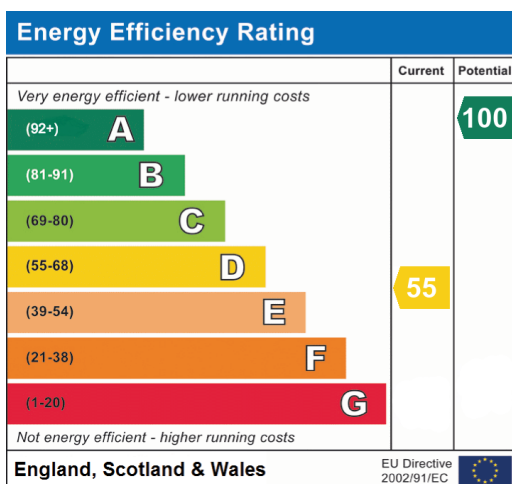



20-22 Bridge End, Leeds, LS1 4DJ
t: 0330 004 0050 e: hello@bettermove.co.uk
www.bettermove.co.uk