



**Axe Valley Close
Mosterton
Beaminster
Dorset
DT8 3JE**

Offers in Excess of £430,000

bettermove

Axe Valley Close

Beaminster

Bettermove are proud to present this 3 bedroom bungalow in Mosterton.

This property benefits from double glazing, solar panels, electric economy heating 7 system and LPG gas heating, with ample off road parking available.

The council tax band is D.

The interior of this beautifully presented property comprises a spacious living room, fitted kitchen/diner, conservatory, WC, three bedrooms and the family bathroom. The exterior boasts a double garage, and a private rear garden, with both patio and lawn, giving beautiful countryside views, perfect for enjoying the summer months.

Located on a quiet cul-de-sac, in the popular village of Mosterton, Beaminster, the property is close to a range of amenities including shops, supermarkets, restaurants and pubs. Excellent transport links can be found from Crewkerne Railway Station and a variety of local bus routes.

This exciting opportunity should not be missed! All enquiries can be made through Bettermove on 0330 004 0050.



GROUND FLOOR

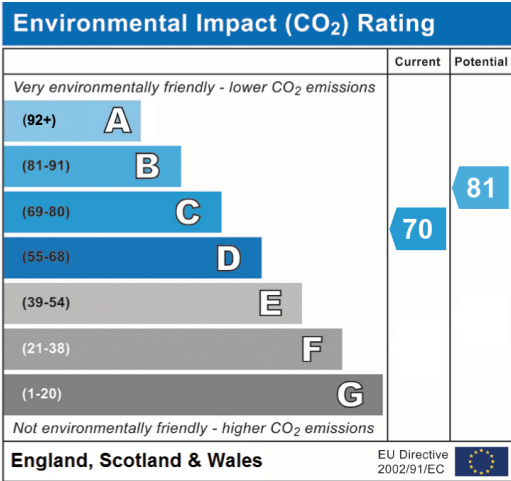
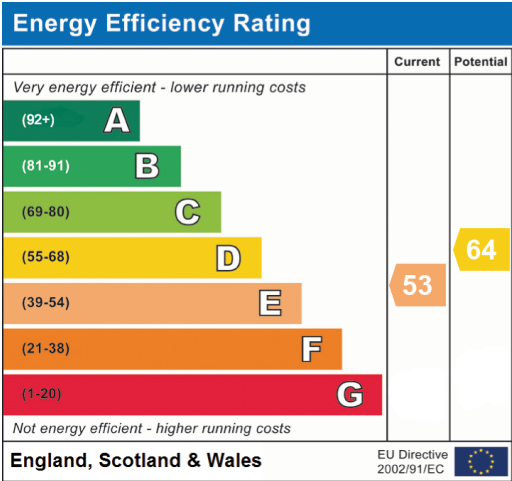
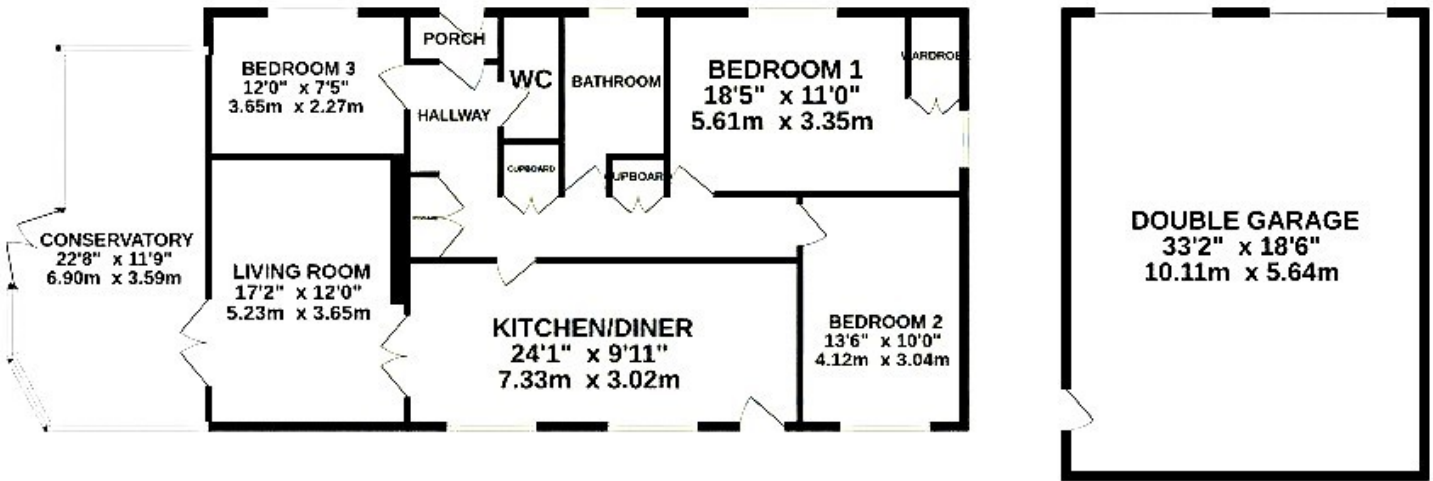



20-22 Bridge End, Leeds, LS1 4DJ
t: 0330 004 0050 e: hello@bettermove.co.uk
www.bettermove.co.uk