



**Mount Pleasant Drive  
Telford  
Shropshire  
TF3 1QL**

**Offers In Excess Of £148,000**

**bettermove**

# Mount Pleasant Drive Telford

Bettermove are proud to present this 2 bedroom terraced house in Telford.

The property benefits from double glazing, gas central heating throughout and has off street parking available.

The council tax band is A.

The interior of this beautifully presented property comprises a spacious living room, conservatory and fitted kitchen on the ground floor. The first floor consists of 2 bedrooms and the family bathroom. The exterior boasts a private rear garden, perfect for enjoying the summer months.

Located in the popular town of Telford, the property is close to a range of amenities, including shops, supermarkets, restaurants and pubs. Excellent transport connections can be found from the A4169, A442 and local bus routes.

This exciting opportunity should not be missed! All enquiries can be made through Bettermove on 0330 004 0050.





GROUND FLOOR

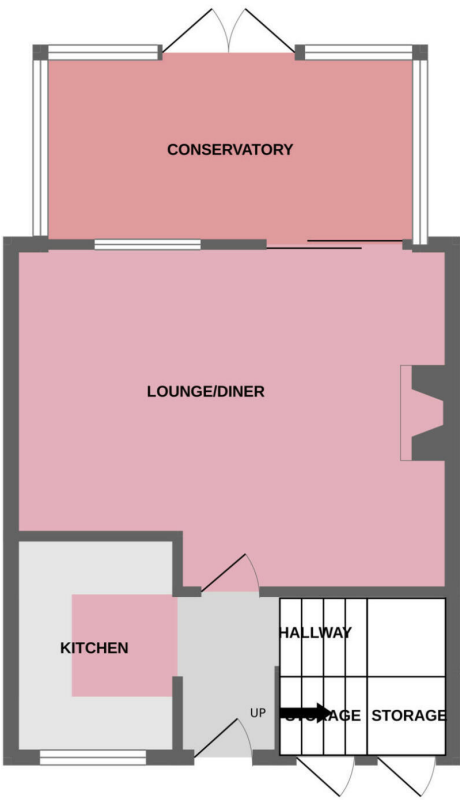

1ST FLOOR

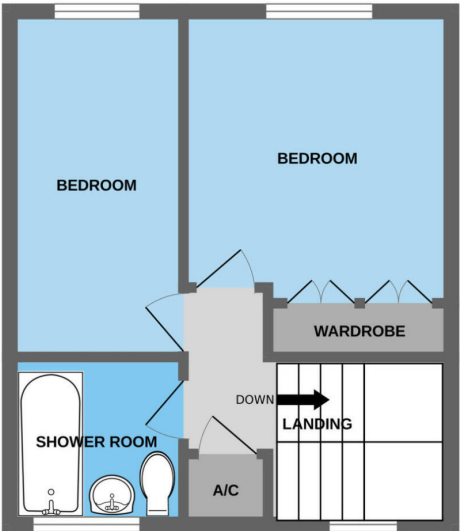

Made with Metropix ©2024

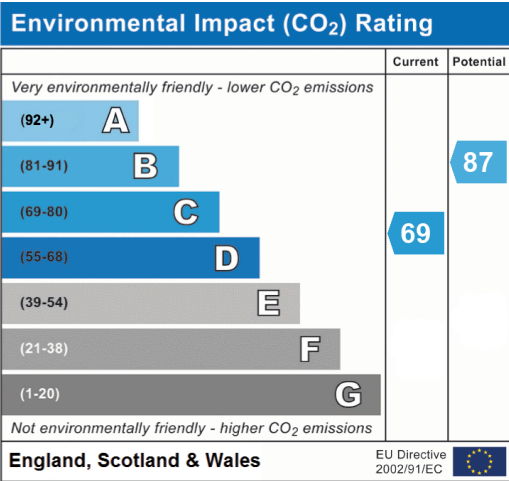
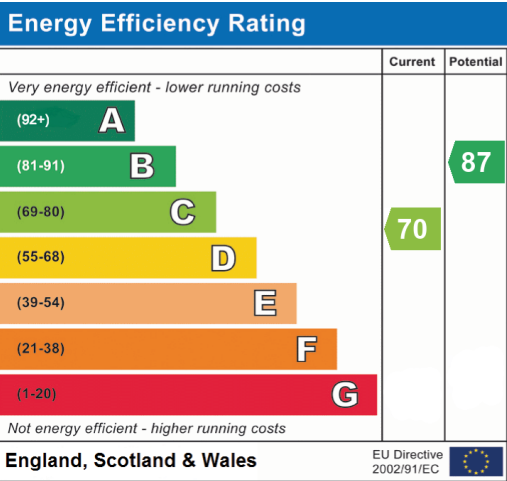



20-22 Bridge End, Leeds, LS1 4DJ  
t: 0330 004 0050 e: [hello@bettermove.co.uk](mailto:hello@bettermove.co.uk)  
[www.bettermove.co.uk](http://www.bettermove.co.uk)

Please Note: These particulars, whilst believed to be accurate are set out as a general outline only for guidance and do not constitute any part of an offer or contract. Intending purchasers should not rely on them as statements of representations of fact, but must satisfy themselves by inspection or otherwise as to their accuracy. No person in this firm's employment has the authority to make or give any representation or warranty in respect of the property.