



Oak Drive
Burscough
Ormskirk
Lancashire
L40 5BU

Offers In Excess Of £340,000

bettermove 

Oak Drive

Ormskirk

Bettermove are proud to present this 5 bedroom detached house in Ormskirk available with no forward chain.

The property benefits from double glazing, gas central heating throughout and has off street parking available.

The council tax band is E.

This is a leasehold property with 250 years on the lease from 2016; the ground rent and the service charge is £295pa.

The interior of this beautifully presented property comprises a spacious living room, office, wc and fitted kitchen on the ground floor. The first floor consists of 4 bedrooms, en-suite to master and the family bathroom. The exterior boasts a private rear garden, perfect for enjoying the summer months.

Located in the popular town of Ormskirk, the property is close to a range of amenities, including shops, supermarkets, restaurants and pubs. Excellent transport connections can be found from the A5209, A59 and many local bus routes.

This exciting opportunity should not be missed! All enquiries can be made through Bettermove on 0330 004 0050.



Total Approx. Floor Area 1365 Sq.ft. (126.8 Sq.M.)

Whilst every effort is made to accurately reproduce these floor plans, measurements are approximate, not to scale and for illustrative purposes only

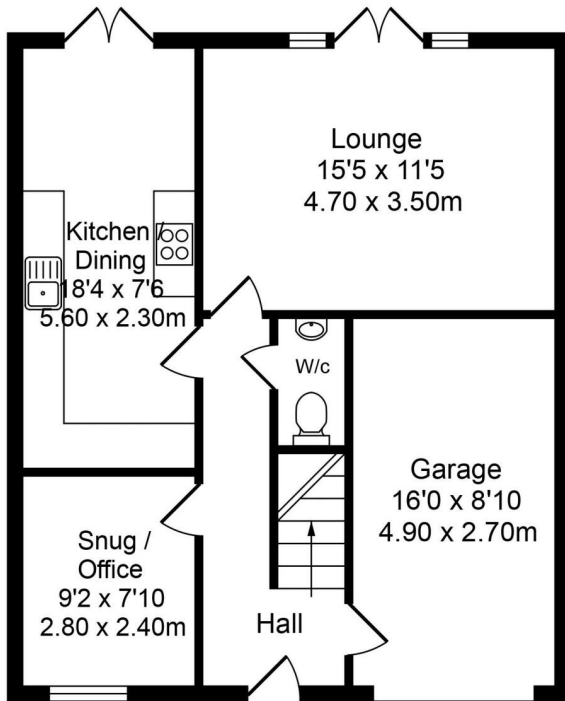

Ground Floor

Approx. Floor Area 650 Sq.Ft (60.4 Sq.M.)

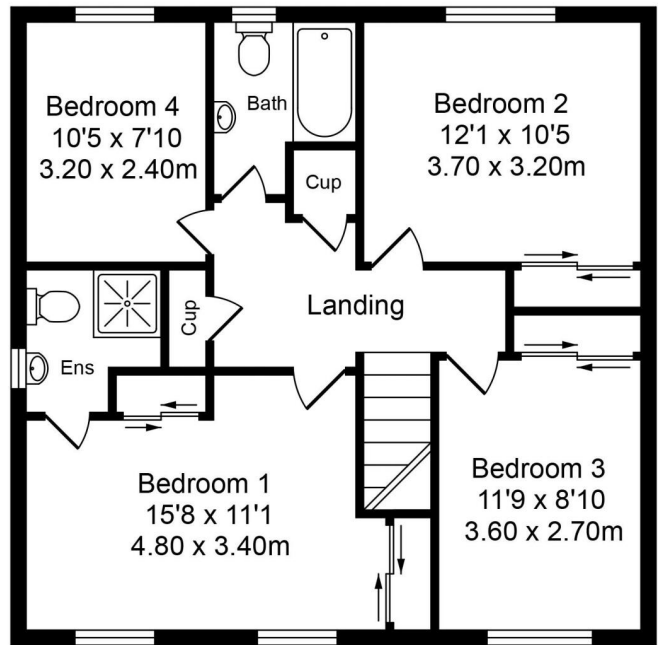

First Floor

Approx. Floor Area 715 Sq.Ft (66.4 Sq.M.)

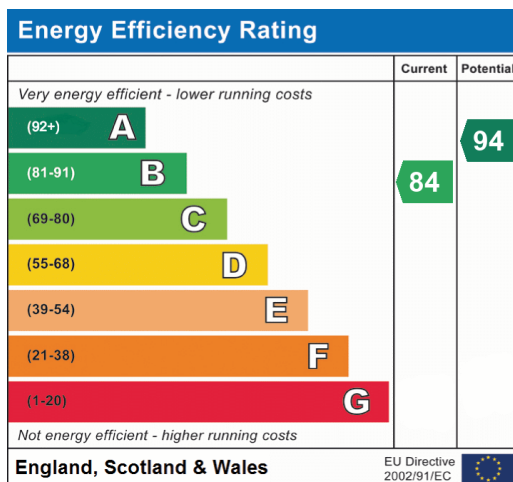



20-22 Bridge End, Leeds, LS1 4DJ
t: 0330 004 0050 e: hello@bettermove.co.uk
www.bettermove.co.uk